

HIGHWAYS ADVISORY COMMITTEE

26 April 2016

Subject Heading:

Proposed road closure in Park End Road by Romford Library - Outcome of public consultation.

CMT Lead:

Andrew Blake-Herbert

Report Author and contact details:

**Musood Karim
Principal Engineer Assistant
01708 432804
masood.karim@havering.gov.uk**

Policy context:

**Havering Local Development Framework (2008).
Havering Local Implementation Plan 2014/15 – 2016/17 Three year delivery plan (2013).**

Financial summary:

The estimated cost of £1,000 for the improvements would be met from the Council's 2016/17 Revenue Budget for Minor Safety Improvements for Borough Roads.

The subject matter of this report deals with the following Council Objectives

Havering will be clean and its environment will be cared for	<input checked="" type="checkbox"/>
People will be safe, in their homes and in the community	<input checked="" type="checkbox"/>
Residents will be proud to live in Havering	<input type="checkbox"/>

SUMMARY

This report sets out the responses to a consultation for the removal of existing metal gates at the southern end of Park End Road, Romford and replacing it with lockable bollards which will allow the passage for emergency services, cyclists and pedestrians. It further seeks a recommendation that the proposals be implemented.

The scheme is within **Romford Town** ward.

RECOMMENDATIONS

That the Committee having considered the report and the representations made, recommends to the Cabinet Member for Environment that the following measures are implemented:

1. **Proposed location of road closure**

Park End Road, Romford, southern end – the proposed road closure situated at a point 59 metres south-east of the south-eastern kerb line of Church Lane as shown on drawing nos. QL040-045-04 and QL040-045-05.

2. For clarification purposes the following vehicular categories would be exempted from the prohibition:

- i) Pedal cycles to gain access to the cycle parking outside the library, maintain through journey etc.
- ii) Fire Brigade, Police and ambulance vehicles being used in emergency;
- iii) A vehicle being used in service of a local authority whilst undertaking a statutory power of duty such as highway maintenance, street cleansing etc.
- iv) Any vehicle for the purpose of loading or unloading goods from premises in or adjacent to the prescribed length of street (essentially Romford Library).

3. That it be noted that the estimated cost for implementation is £1,000 which would be met from the Council's 2016/17 Revenue Budget for Minor Safety Improvements for Borough Roads.

REPORT DETAIL

1.0 **Background**

- 1.1 The existing metal gate was installed at the southern end of Park End Road to stop vehicular traffic by the Romford Central Library. The gate was installed in an area with high pedestrian movements which mainly consists of school children, local residents, shoppers, council staff etc. Some drivers were seen reversing their vehicles and this was considered to be dangerous especially in the close vicinity of the Romford Central library where people of all ages frequently visit.
- 1.2 The existing metal gate was installed in haste on safety grounds without any Traffic Orders to close a section of the public highway. The narrow area on both sides of the gate has resulted in restrained access for wheel chair users, cyclists etc.

2. **Proposals to remove the existing metal gate and replacing it with removable bollards**

It is proposed to remove the existing metal gate and replacing it with removable bollards. The excess would be controlled by lockable bollards which will allow access for the emergency vehicles, pedestrians, mobility scooters etc. Emergency services have a standard key to unlock the bollards during emergency periods. The proposals are shown on attached drawing nos. QL040-045-04 and QL040-045-05.

3. **Outcome of the Public Consultation**

- 3.1 A draft traffic order was advertised in the local press (Romford Recorder and London Gazette) and the emergency services were consulted. Being relatively a minor scheme public notices were displayed on site thus giving opportunity to anyone living in the local area to provide their comments.
- 3.2 The proposals were advertised in the local press and notices were placed on site. The closing date for receipt of representations was 26th February 2016. By the close of consultation, 93 responses were received. The responses are summarised in Appendix 1 of this report.
- 3.3 The results of the consultation shows that majority of the respondents ie 93.5% have objected the road closure. Majority of the respondents are parishioners attending St. Edward the Confessor Catholic Church in Romford had used identical letters provided by the church. After discussion with the church it became clear that it was perceived by the respondents that the closure was proposed between Church Lane and the Romford library which would affect the

main entrance of the church, whereas the proposals are limited to the area by the library.

- 3.4 The consultation drawing clearly shows the location of the closure is at the existing metal gate by the library which was installed on safety grounds to protect pedestrians in that immediate area. The current proposal relates to maintain the same area being closed to traffic, but it would be supported by a traffic management order which would legally justify it's installation. In addition, the bollards will allow better access for mobility scooter users, pedestrians and cyclists.
- 3.5 It is, therefore, recommended that the proposals to remove the existing metal gate and replacing it with lockable bollards are agreed. It is anticipated that the new measure will enhance safety in an area with high pedestrian movements, wheel chair users, cyclists etc.

IMPLICATIONS AND RISKS

Financial implications and risks:

This report is asking HAC to recommend to the Cabinet Member the implementation of the above scheme.

The estimated cost for implementation is £1,000, which will be met from the Council's 2016/17 Revenue Budget for Minor Safety Improvements for Borough Roads.

The costs shown are an estimate of the full costs of the scheme, should all proposals be implemented. It should be noted that subject to the recommendations of the committee a final decision then would be made by the Lead Member – as regards to actual implementation and scheme detail. Therefore, final costs are subject to change.

This is a standard project for Streetcare and there is no expectation that the works cannot be contained within the cost estimate. There is an element of contingency incorporated into the financial estimate. In the unlikely event of an over spend, the balance would need to be contained within the overall Streetcare Revenue budget.

Legal implications and risks:

There are legal implications associated with prohibiting or permitting traffic movements at various locations in the highway network, therefore, it requires public advertisement of traffic management orders and consulting the local frontages in the immediate vicinity.

Human Resources implications and risks:

None.

Equalities Implications and risks:

The Council has a general duty under the Equality Act 2010 to ensure that its highway network is accessible to all users. Where infrastructure is provided or substantially upgraded, reasonable adjustments should be made to improve access. In considering the impacts and making improvements for people with protected characteristics (mainly, but not limited to disabled people, the young and older people), this will assist the Council in meeting its duty under the Act.

BACKGROUND PAPERS

Project file: QL40 - 045 – Park End Road, proposed road closure.

Appendix 1

Summary of Consultation Responses

**Park End Road, Romford
Results of the Public Consultation**

No	Property No	Road Name	Agree Closure	Disagree Closure	Identical letter	Comments	
1	7	Beechfield Gardens		1	Y	Most contents similar to identical letter. Cannot imagine walking with a coffin and seeing a bride walking to the Church in rain.	
2	15	Burnside Court South Street, Romford		1	Y		
3	32	Carlton Road		1	Y		
4	29	Cedar Road		1	Y		
5	4	Western Court, Chandlers Way		1	Y		
6	22	Crossways, Gidea Park		1	Y		
7	74	Dee Way, Rise Park		1	Y		
8	9	Devent Court, Riverside Cl		2	Y		2 responses received from same address
9	16	Dorset Avenue		2	Y		2 responses received from same address.
10	41	Eastern Avenue East		1	Y		
11	95A	Eastern Road		1	Y		
12	162	Eastbrook Drive, Rush Grn.		2	Y		2 responses received from same address

13	4	Erroll Road		1	Y	
14	11	Glenwood Drive		1	Y	
15	46	Heath Drive		1	Y	
16	1	Hill Grove		2	Y	2 responses received from same address

No	Property No.	Road Name	Agree Closure	Disagree Closure	Identical letter	Comments
17	17A	Kingston Road		1		The Church is visited throughout the day by many parishioners at various times of the day. The respondent delivers flowers to the Church which are heavy to carry, so direct access is required. In addition, the tax payers money has not been in updating the parking facilities at this section of the road.
18	17B	Kingston Road		1	Y	
19	83	Lake Rise		1	Y	
20	97	Lake Rise		1	Y	
21	72	Links Avenue		1	Y	
22	79	Links Avenue		1	Y	

23	171	Lodge Avenue		1	Y	
24	152-182	London Road		2	Y	Apartment No. 17
25	342	London Road		1	Y	
26	83	Main Road		1	Y	(Flat no 1)
27	21	Mashiters Walk		1	Y	
28	27	Mashiters Walk		1	Y	
29	30	Mashiters Walk		1	Y	
30	35	Mashiters Walk		3	Y	3 responses received from same address
31	45	Mashiters Walk		1	Y	
32	66	Mashiters Walk		1	Y	
33	75	Mashiters Walk		3	Y	3 responses received from same address
34	15	Maple Street		1	Y	
35	51	McIntosh Road		1		Partly identical letter and the respondent wants to see the withdrawal of the proposals

No	Property No	Road Name	Agree Closure	Disagree Closure	Identical letter	Comments
36	25	Oaklands Avenue		1		Although the church has access at the rear via Church Lane, the road closure would cause inconvenience to funerals & weddings and others requiring direct access

						to front side of the church. Church Lane permits one way traffic which means that drivers will have to negotiate the Ring Road to access the rear entrance.
37	17	Parkside Avenue	1			The road closure order would be extremely difficult for funerals, weddings, baptisms or veryday Masses . The Parish Priest is often upon at late night visits of hospitals or the sick in response to emergency calls.
38	39	Parkside Avenue	1		Y	
39	44	Parkside Avenue	1		Y	
40	52	Parkway	1		Y	
41	5	Park End Road St Edward the Confessor Catholic Parish, Romford	1			The Catholic Community have been visiting the Church since 1856. This applies at the weekends and other Church services. The only entrance to the Church is vai Park End Road. The Church receives deliveries via Park End Road and closure would mean considerable loss to the Church and the community.
42	37	Park End Road	2		Y	2 responses received from ssame address
43	68	Park End Road	1		Y	
44	52	Parkway	1		Y	
45	304	Pettits Lane North	1		Y	
46	32	Richards Avenue	1		Y	
47	61	Rose Lane, Marks Gate	2		Y	2 responses received from same address
48	8	Rosemary Avenue	2		Y	2 responses received from ssame address
49	45	Rushden Close	1		Y	

50	38	Seymer Road		1	Y	
51	148	Stanley Avenue		1	Y	

No	Property No	Road Name	Agree Closure	Disagree Closure	Identical letter	Comments
52	10	St Edwards Way, Romford		1		The respondent was very upset to hear about the proposed closure of section of Park End Road. The church needs a clear access for Mass, weddings and funerals.
53	5	The Avenue		1		Has been a member of congregation of St Edwards Catholic Church for 60 years. He has used the access for 6 weddings, 6 christenings and many funerals. The closure isolate the Catholic community & church.
54	32	The Chase		1	Y	
55	22	The Ridgeway		2	Y	2 responses received from ssame address
56	594	Upper Brentwood Road		1	Y	
57	13	Coope Court, Union Rd.		1	Y	Has requested to reconsider the proposal.
58	2	Victoria Court, Romford		1		Identical response including additional information As a disabled person it is hard enough to get around so please think about the elderly old age pensioners.
59	55	Willow Street		4	Y	4 responses received from same address
60		Metropolitan Police, Roads & Transport Policing	1			

		Command Unit.				
61		London Fire Brigade	1			
62		London Cycle Campaign, Havering branch	1			
63		London Taxi and Private Hire, part of Transport for London	1			
		<u>No addresses</u>				
64		Responent 1		3	Y	3 responses from same address.
65		2		1	Y	
66		3		1	Y	
67		4		1	Y	
68		5		1	Y	

No	Property No	Road Name	Agree Closure	Disagree Closure	Identical letter	Comments
69		6		1	Y	Dolphin Approach, Romford The proposals will not prevent access to the church Fully supports the road closure. Prior to closure it was a potential danger to the pedestrians.
70		7		1	Y	
71		8		1	Y	
72		9		1	Y	
73		10	1			
74		11	1			
75		12		1	Y	

Total	6	87	
--------------	----------	-----------	--

Summary of Responses	
No of responses received	93
% of objections	93.5
% of agreement	6.5

Appendix 2

Plan showing details of
proposed road closure

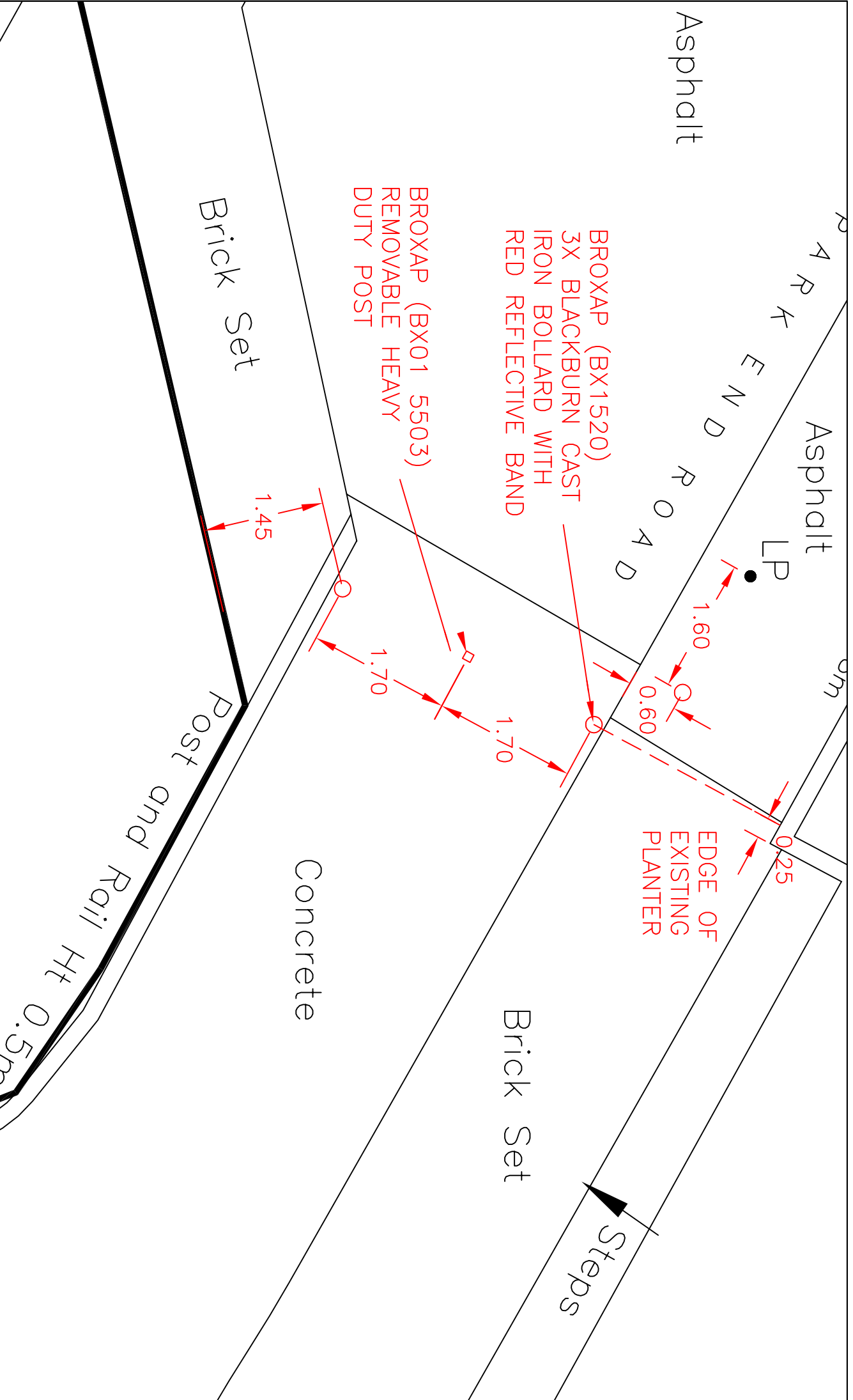

Haivering

STREETCORE COMMUNITIES & RESOURCES
TRAFFIC & ENGINEERING
10th FLOOR MERCURY HOUSE
MERCURY GARDENS, ROMFORD, RM1 3DW
TELEPHONE No: 01708 434343 FAX No: 01708 433721
E-MAIL: streetcore@haivering.co.uk

JOB TITLE
ROMFORD LIBRARY OPEN SPACE
VEHICLE MANAGEMENT

DRAWING TITLE
PROPOSED ROAD CLOSURE
GENERAL ARRANGEMENT

DRAWN BY
MLP

SCALE (AT A4 SIZE)
NTS

ACAD REF:
Sheet Size: A4 (297x210)

CHECKED BY
MLP

DATE
JAN '16

DRAWING No
Q1040-45-04

APPROVED BY
MLP

ISSUE
DRAFT

REVISION
-

PURPOSE
PROPOSED

AMENDMENT

DATE

©COPYRIGHT
This drawing belongs to StreetCore Culture & Community, Traffic & Engineering Section. Neither the whole nor any part thereof may be reproduced without prior written permission.

Based upon Ordnance Survey Mapping with the permission of the Controller of Her Majesty's Stationery Office © Crown copyright. Unauthorised reproduction infringes Crown copyright and may lead to prosecution or civil proceedings. London Borough of Havering 100024327

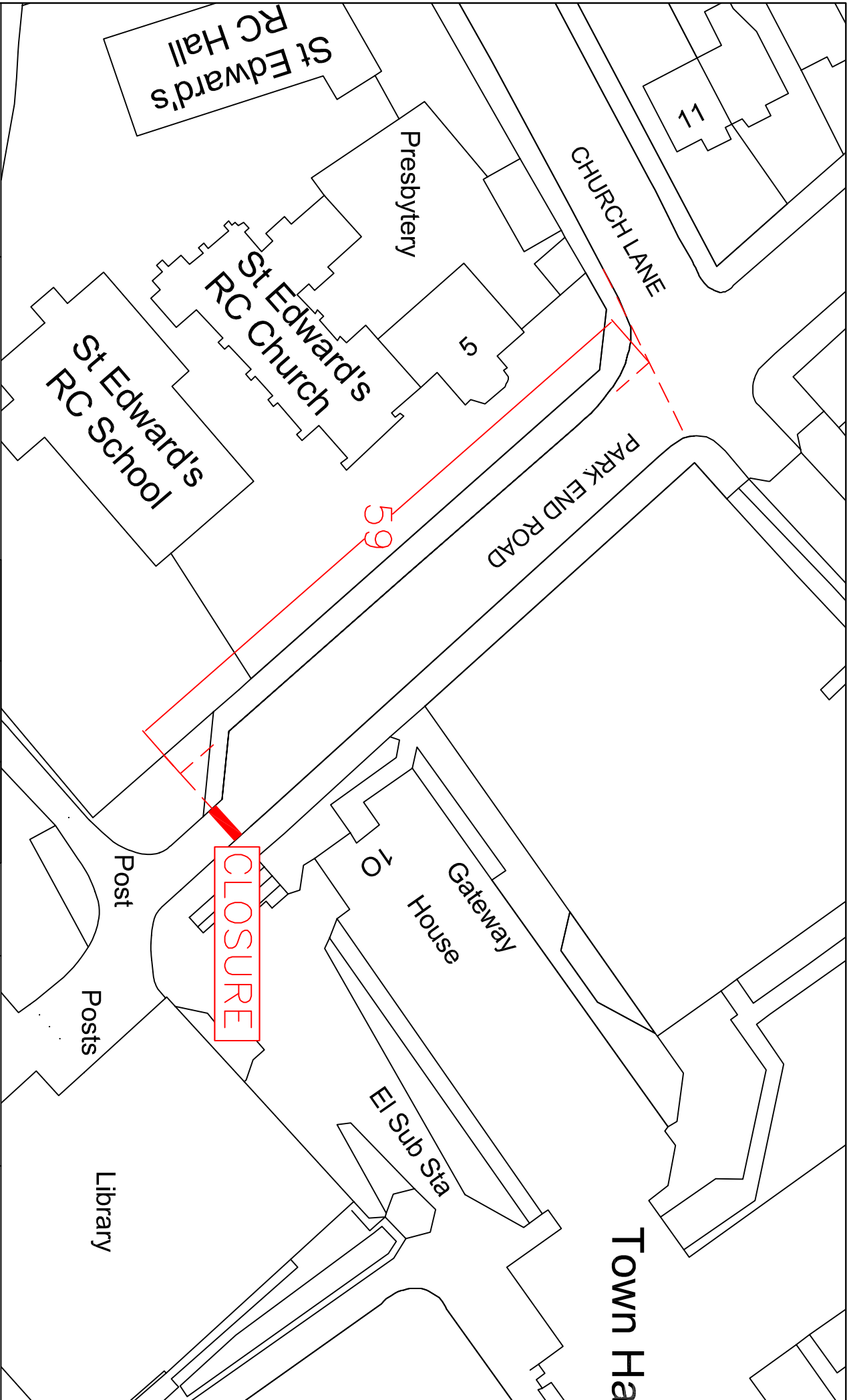

Havering
LONDON BOROUGH

STREETCARE COMMUNITIES & RESOURCES
TRAFFIC & ENGINEERING
10th FLOOR MERCURY HOUSE

MERCURY GARDENS, ROMFORD, RM1 3DW
TELEPHONE No: 01708 434343 FAX No: 01708 433721
EMAIL: streetcare@havering.gov.uk

JOB TITLE
ROMFORD LIBRARY OPEN SPACE
VEHICLE MANAGEMENT

DRAWING TITLE
POSITION OF PROPOSED ROAD CLOSURE

DRAWN BY MLP	CHECKED BY MLP	APPROVED BY MLP	PURPOSE	PROPOSED	DATE
SCALE (AT A4 SIZE) NTS	DATE JAN '16	<input checked="" type="checkbox"/> DRAFT <input type="checkbox"/> ISSUE			
ACAD REF:	DRAWING No QL040-45-05	REVISION	REVISION	AMENDMENT	DATE
Sheet Size: A4 (297x210)					

©COPYRIGHT
This drawing belongs to Streetcare Culture & Community, Traffic & Engineering Section. Neither the whole nor any part thereof may be reproduced without prior written permission.
Based upon Ordnance Survey Mapping with the permission of the Controller of Her Majesty's Stationery Office © Crown copyright and may lead to prosecution or civil proceedings. London Borough of Havering 100023527